

The EXTOL Enterprise Adapter (EEA) family of integration products provides design-time and runtime interface components that integrates Oracle E-Business Suite systems with external trading partners, internal applications and enterprise data using XML, EDI, spreadsheet, flat file, and database content.

The EXTOL Enterprise Adapter package consists of separately packaged collections of interface components and pre-built sample transactions that work with the EXTOL Business Integrator (EBI) base product.

The EXTOL Enterprise Adapter packages are designed to enable rapid integration of application-to-application (A2A) and business-to-business (B2B) integration processes, and to work seamlessly with EXTOL's EBI product to provide centralized configuration and control for all communications and data integration activity for Oracle E-Business Suite systems.

EXTOL Enterprise Adapter – Oracle E-Business Suite integration overview

The EXTOL Enterprise Adapter leverages EXTOL integration middleware to enable A2A/B2B integration to and from Oracle E-Business Suite systems.

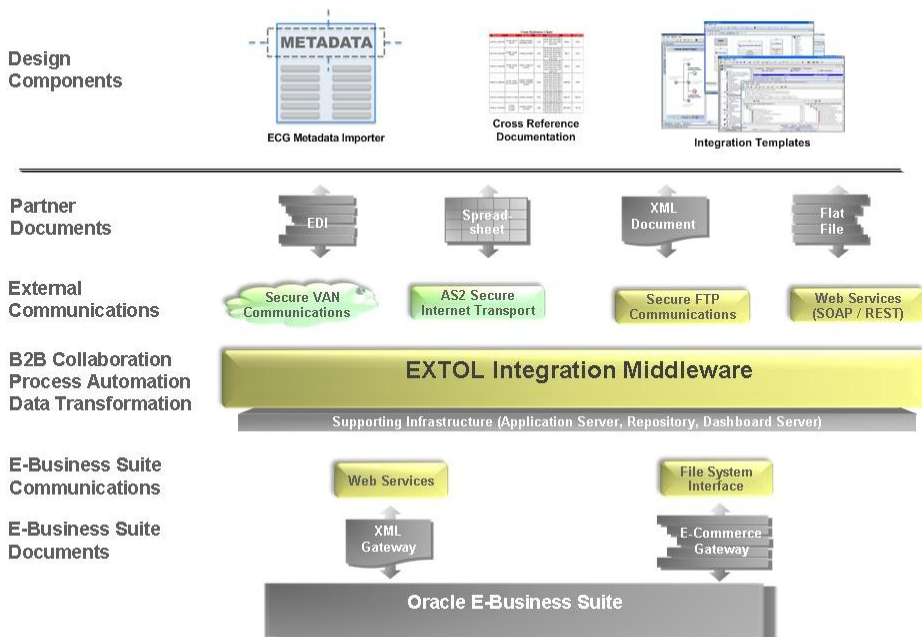

EXTOL Enterprise Adapter – Functions and Features for Oracle E-Business Suite

Oracle E-Business Suite exposes two (2) main external interfaces that can be used for application integration: e-Commerce Gateway (ECG) and XML Gateway (XMG). The EEA product supports both, through the following features:

- ECG-specific metadata import:** The EEA product enables metadata management features EBI base product for generation of internal ECG file definitions from imported ECG file metadata. The EBI product also imports DTD's, XSD's and W3C v1.1 WSDL for documents that are sent and received using web services.

- **EDI transaction examples:** The EEA product contains sample EDI configuration objects for the following X12/ECG transaction combinations:

| Direction | X12 ID | X12 version | ECG ID |
|-----------|--------|-------------|--------|
| Inbound | 850 | 4010 | POI |
| Outbound | 856 | 4010 | DSNO |
| Outbound | 810 | 4010 | INO |

Users of the EEA-EBS product can use these object sets as “base” configurations, and revise, as needed, to meet specific integration project requirements.

- **Implementation documentation:** The EEA product includes Installation and User Guides, plus a full source / target cross reference for the EDI transactions listed above, including notes on specific message- and segment-level processing requirements.

Using the EXTOL Enterprise Adapter with Oracle E-Business Suite

Traditional E-Business Suite integration can be time consuming, expensive, and disruptive to business and IT operations. The EEA product was designed to address common obstacles encountered during ORACLE E-BUSINESS SUITE integration projects, and streamline delivery of applications for production use.

Using the EEA product entails the following steps:

1. Install and license the EEA product for use with your EBI base product.
2. Choose the EBS document type: ECG or XML.
3. Generate/Import ECG file metadata or the appropriate DTD/XSD/WSDL for XML/Web Services.
4. Choose the integration mechanism: File System or Web Services.
5. Create or customize the Source / Target cross reference specification that governs the transformation you need from input document to output document.
6. For EDI integration cases where a sample transformation is supplied, modify one of the supplied transformations; otherwise create your own transformation that specifies the set of actions needed to produce the desired output from available input(s).
7. Create or modify / configure adapters, business processes, and other components needed to complete your business transaction.
8. Test the resulting integration application and when it runs successfully, deploy to your production environment.

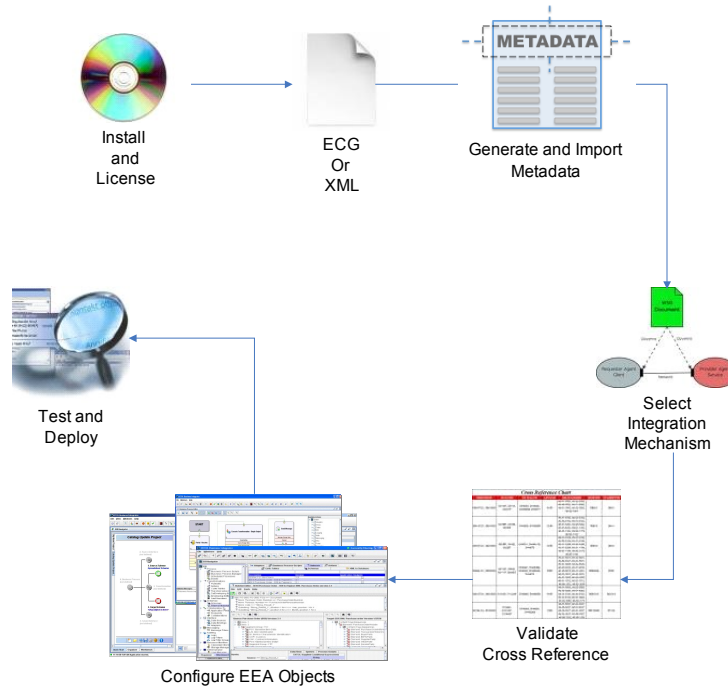

Product Packaging and System Requirements

The EEA product is an add-on module for the EXTOL Business Integrator base product. EEA is separately installed on top of the EBI base product and activated by a license code. The module requires 100MB of disk storage, excluding transaction data storage requirements. For a complete list of supported platforms and system requirements, refer to the EBI Product Overview.

Professional Services from EXTOL

In the majority of cases, EXTOL Enterprise Adapter is sold as part of a package that includes Professional Services assistance from EXTOL, to ensure that each customer gets the assistance they need with base product integration and usage, requirements analysis, project planning, pilot implementation, and ongoing operations.

The EXTOL Professional Services staff has extensive experience with Oracle E-Business Suite integration project design and deployment. Typical Professional Services engagements involve pilot projects focused on tangible results and technical knowledge transfer.

Oracle E-Business Suite Application Examples

The following implementation scenarios for Oracle E-Business Suite exemplify the integration uses to which EXTOL Enterprise Adapter can be applied, when used with the EXTOL Business Integrator (EBI) base product:

EDI ↔ Oracle E-Business Suite (ECG): A large customer requires that your company implement Orders, Advance Ship Notices, and Invoices, using X12 EDI. Your IT staff is familiar with Oracle E-Business Suite ECG generation and processing. To meet the customer's requirement, you use EBI to:

- Generate ECG definition files for the required transactions and produce equivalent EBI document schemas using the Metadata Import Wizard.
- Customize the “base” EDI implementations included in the EEA product to suit the requirements stipulated by your customer.
- Test and deploy.

Despite the complexity that attends EDI integration, because this case is directly supported by many features of the EEA product, implementation is significantly faster and easier than using other EDI integration offerings for Oracle E-Business Suite.

Spreadsheet to Oracle E-Business Suite (web service / XML): Your organization uses spreadsheets to gather/record information on the shop floor, in the warehouse, and from your business partners. The spreadsheet data is then manually entered into the Oracle E-Business Suite application. You can use EEA to integrate the spreadsheets directly with Oracle E-Business Suite and eliminate manual data entry by taking the following steps, using EBI:

- Generate document schema(s) from examples of the source spreadsheet(s) used by your organization, using the EBI Spreadsheet Schema Wizard.
- Import DTD’s for each of the target documents and services from XML Gateway Message Designer.
- Create Transformation rules that specify how to create the desired XML documents from the spreadsheet content.
- Configure a File Read adapter for the spreadsheet source files.
- Generate web services consumers to push the required target documents to the XML Gateway provider services.
- Create a business process model to sequence the spreadsheet file read, transformation, and web service-to-XML Gateway transport steps.

Together with the EXTOL Business Integrator, EEA makes it easy to integrate proprietary spreadsheet and flat file data with Oracle E-Business Suite. This is particularly useful when integrating with legacy applications and external customers, suppliers, and business partners that are incapable of interacting using EDI and other structured B2B integration methods.

Customer Portal to Oracle E-Business Suite (web service / XML): You use a Web-based portal service, and want to integrate your customer portal with Oracle E-Business Suite to check on orders and order status. You can use EEA to implement integration with your external portal by taking the following steps:

- Define the XML documents to be used in the XML Gateway Message Designer.
- Import the DTD’s and create EBI XML document schemas that define the order detail and order status documents needed by the web portal.
- Using EBI, generate web services providers for the Orders and Order Status services, and export the WSDLs for use in creating the consumer interfaces in the web portal.
- Create Transformation rules in EBI that specify how to marshal and send the Orders and Order Status and create the outputs requested by the web portal.
- Model a business process to sequence the execution of the required communications and data transformation steps.

At runtime, when a customer requests order status through the external portal, the request is satisfied by the EBI Web Services provider, which receives the request, retrieves the order and status information from Oracle



EXTOL Enterprise Adapter for Oracle

E-Business Suite, transforms the returned data into appropriate XML documents, and returns the results to the web portal.

Why Choose the EXTOL Enterprise Adapter for Oracle E-Business Suite Integration?

- One package supports external (B2B) and internal (A2A) integration for multiple transaction and document types, including EDI, flat file, (and with EXTOL Business Integrator) spreadsheets, XML, and databases.
- Supports both batch and near real time integration with Oracle E-Business Suite.
- No programming required – based upon a model / configure / deploy paradigm.
- Complete, self-contained solution - when used with the EBI base product, there are no other prerequisites to buy.
- Designed for use by project teams with limited budgets and varying technical skill sets.
- Rapid deployment of ECG or Web Services based integration projects.
- Outstanding Customer Care team ready to assist you every step of the way.
- Trust EXTOL – helping customers solve integration challenges on time and under budget for over 18 years